

## STRAIGHT ROMAN POOL SURROUNDS

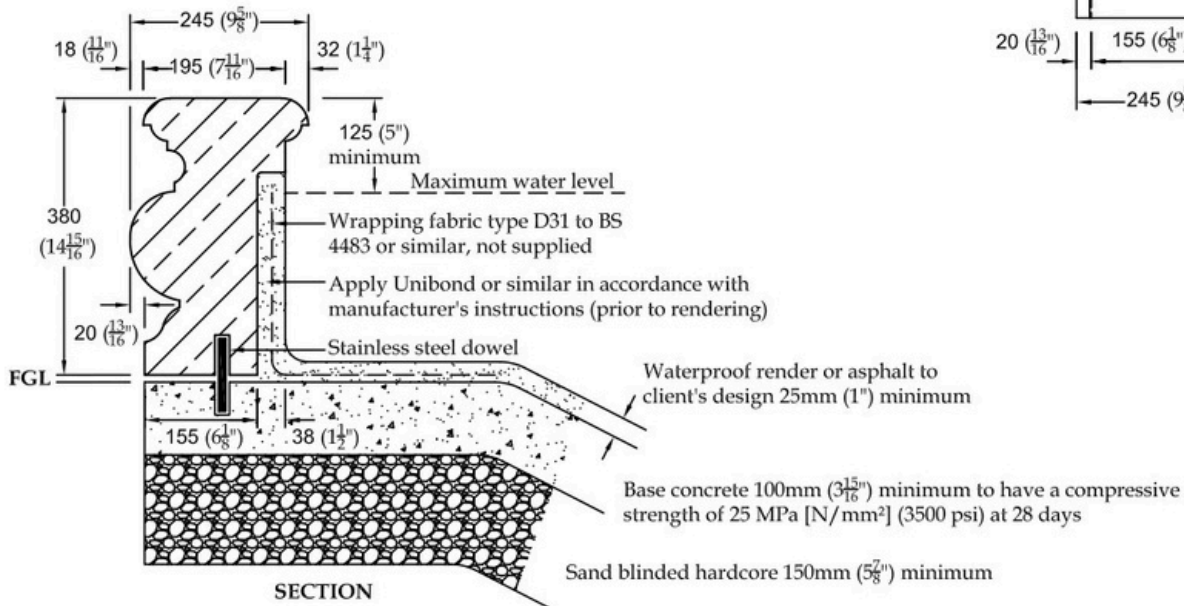
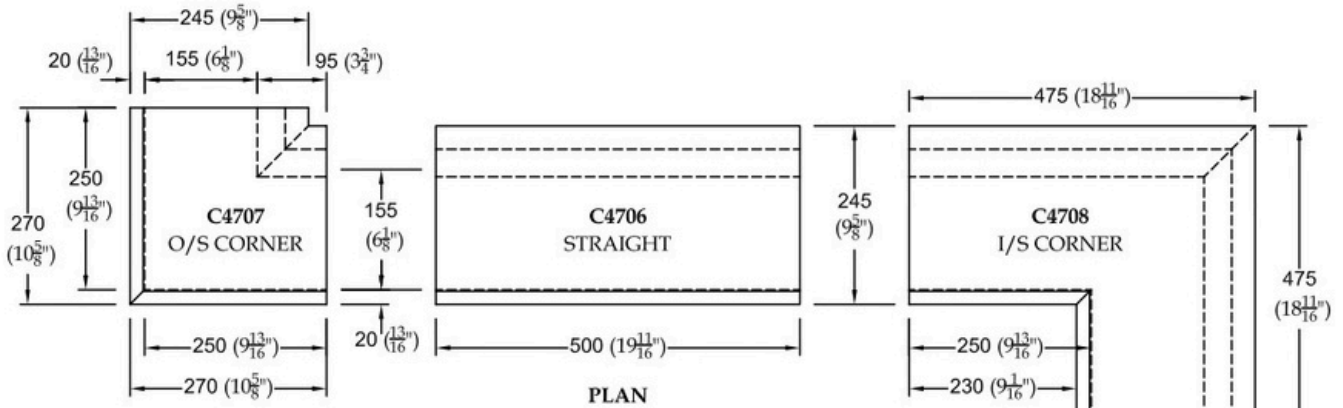

**WEIGHTS:**

C4706 Straight	60 kg	(132 lbs)
C4707 Outside corner	42 kg	(93 lbs)
C4708 Inside corner	84 kg	(185 lbs)

Ø 10mm (3/8") stainless steel dowels (not supplied) 50mm (2") projection into stone. Holes to be drilled on site to suit by others. Minimum of 2 No dowels per stone secured using a flexible building adhesive such as Evode Serious Stuff, Loctite Fast Grab, or similar

To guard against frost damage, drain off water before winter and do not replace it until the hard frosts are past in the following spring

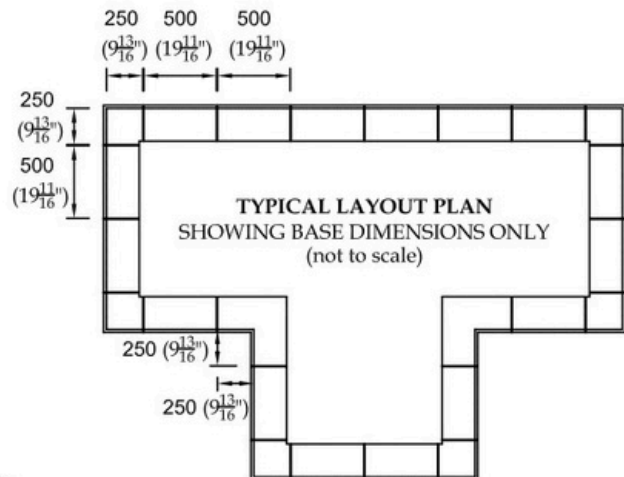

All dimensions exclude joints - allow 6mm (1/4") for vertical and bedding joints  
 Unless otherwise stated, all materials other than stonework to be supplied by others